

CUSTOMER DRAWING

P/N: 3000G 17/

REV  
S

ASS'Y PART NUMBER	① SLEEVE MATERIAL	② TERMINAL MATERIAL	FINISH
3000G 17B	NYLON 6/6, COLOR NATURAL	.032 THK. BRASS	ZINC PLATE
3000G 17D	NYLON 6/6, COLOR NATURAL	.032 THK. BRASS	NONE

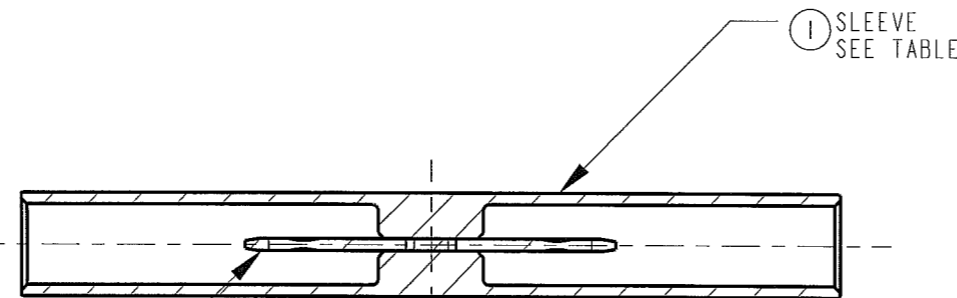
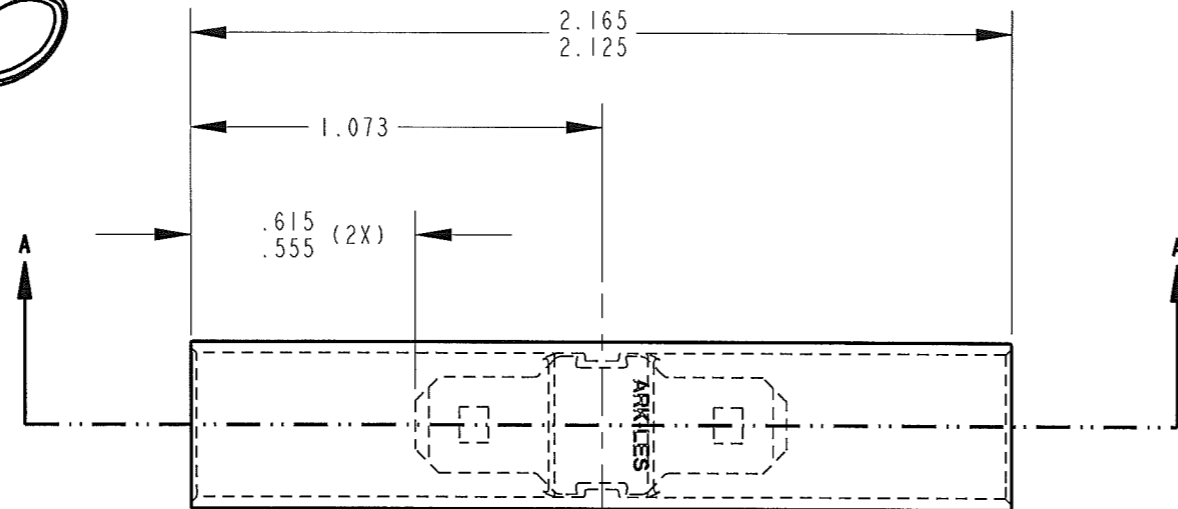

② TERMINAL, BRASS PLATING - SEE TABLE

SECTION A-A

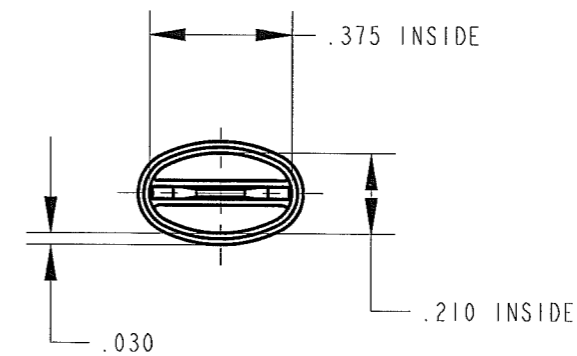

**ARK-LES UNCONTROLLED**

WAS 3000GX 17/ REV 0 (PREL. REL)

PRINT DIST.	PROD. REL.	PER DG	12/17/64(BA)	CHK'D	TOLERANCES UNLESS OTHERWISE SPECIFIED	 STOUGHTON, MA
DEPT #	QUOTE REL.	89092	5/27/64(HK)	APP.	DECIMALS ±.010	
ENG I	DRAWN BY	D.O'NEILL 6/13/07		APP.	METRIC ±0.25mm	<b>ORIGINAL IF RED</b> PART NAME CUSTOMER DRAWING CONNECTOR, INLINE CAD#: 3000G_17-REVS
SALES	SUPERSEDES DWG. DATED:	1/12/98		ET 5/19/08	ANGLES ±1°	
S	REV. PER ECR#	3/05/08	DON	STO X	MATERIAL:	P/N: 3000G 17/
R	REV./REDWN ECR #	6/13/07	DON	RAL	FINISH:	
REV.	DESCRIPTION	DATE	DR.	JZ CHINA	3RD ANGLE PROJECTION DWG SIZE: B	REV S